

BUANDERIE MA

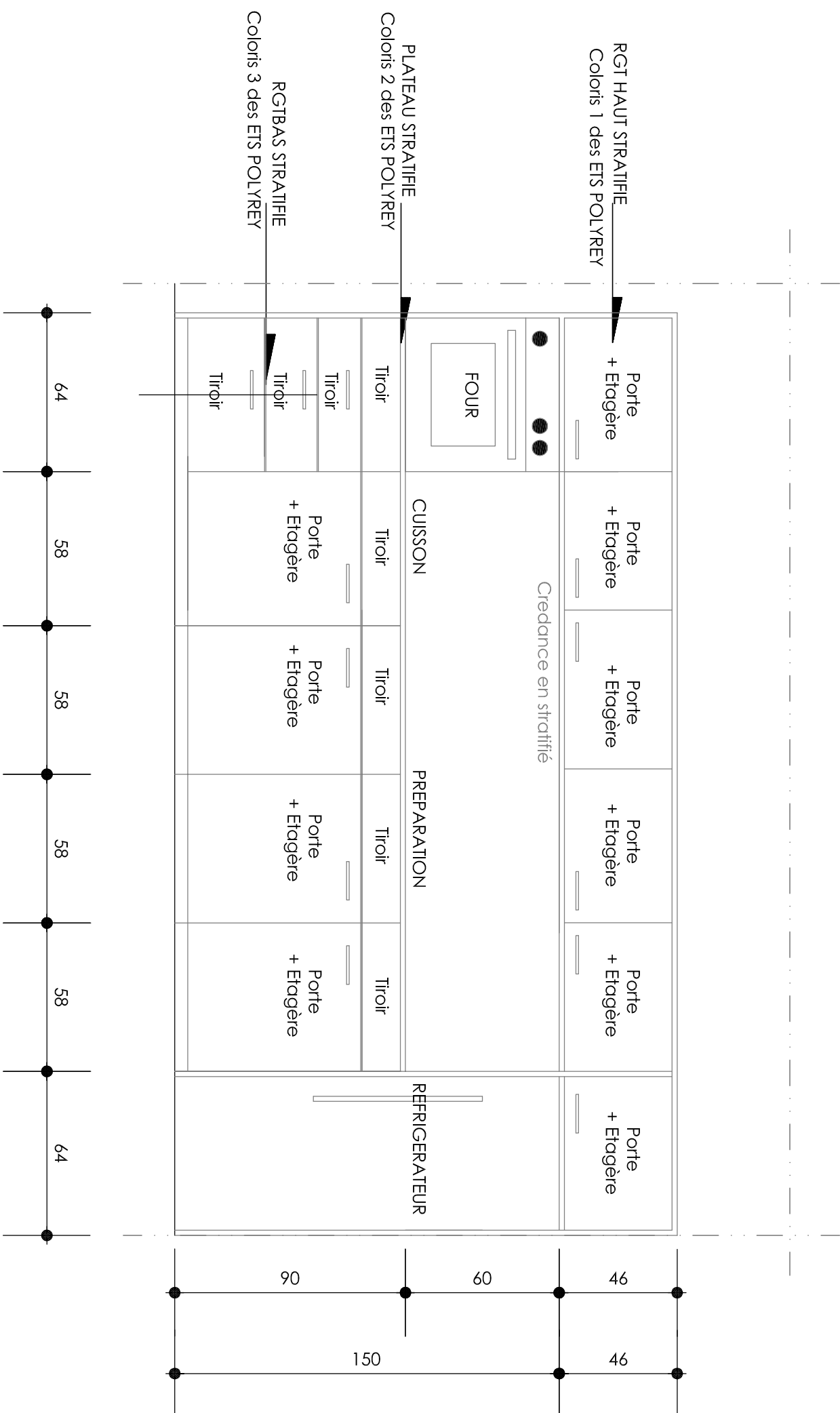

OFFICE MA

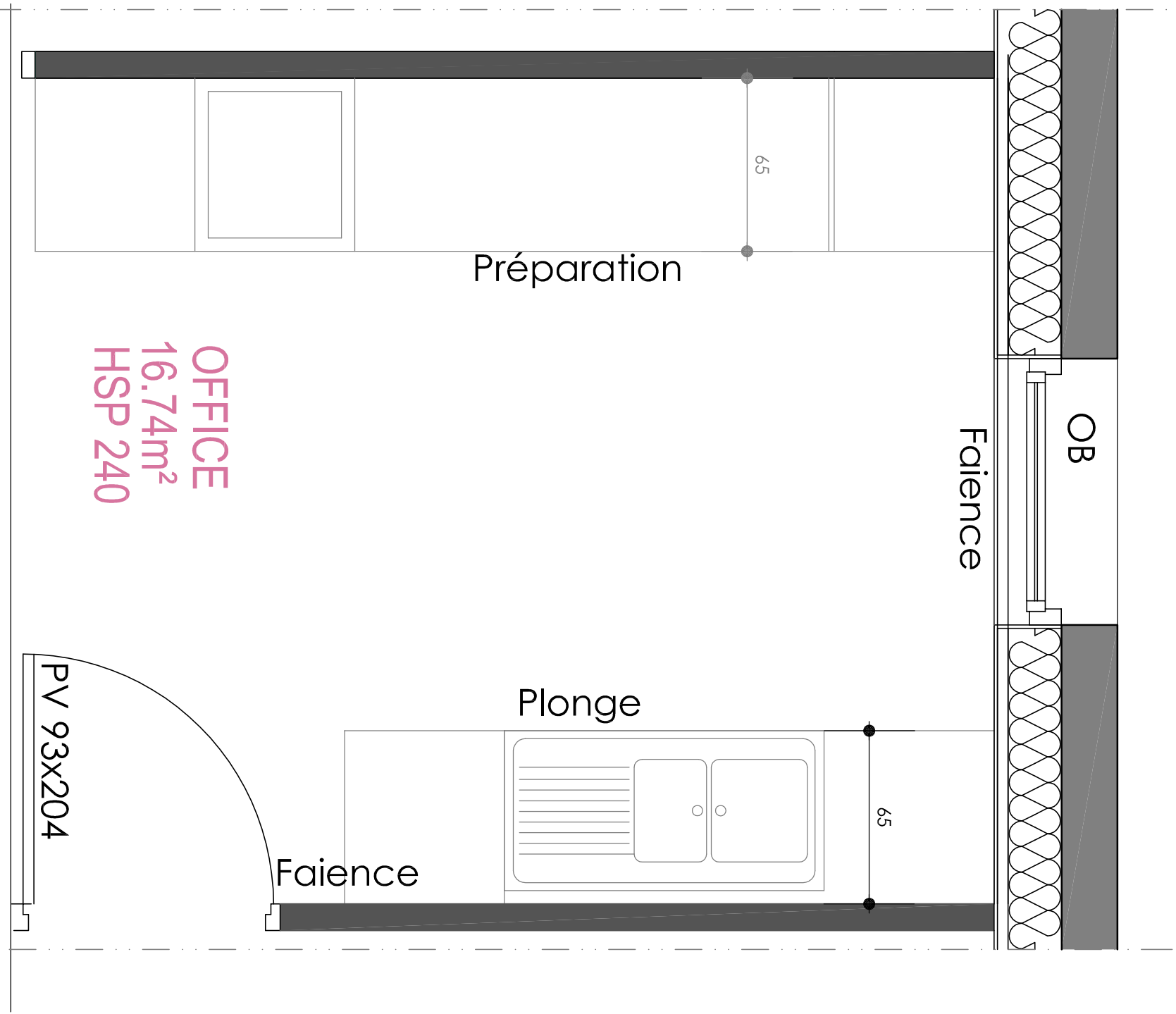
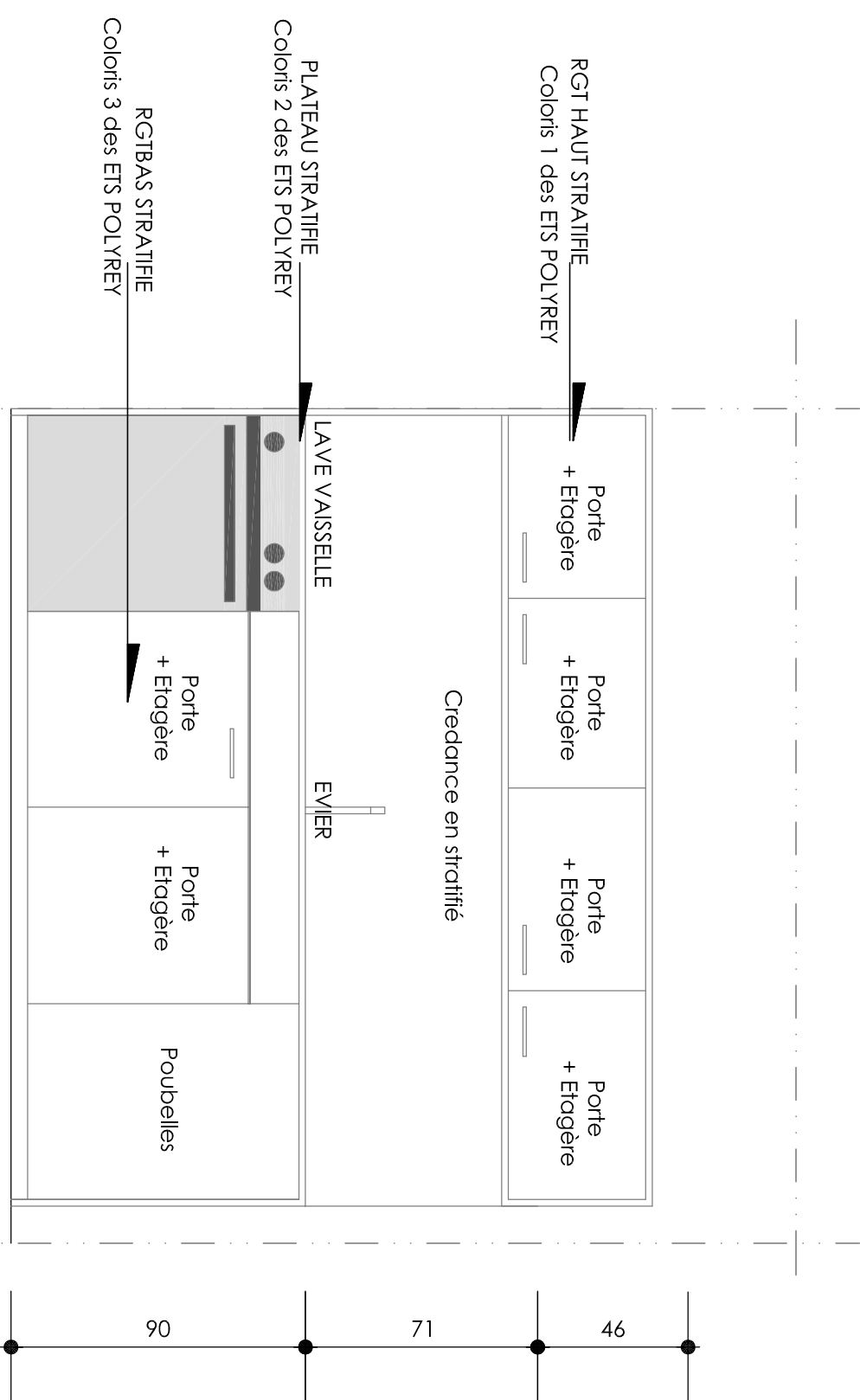

CHANGE MA

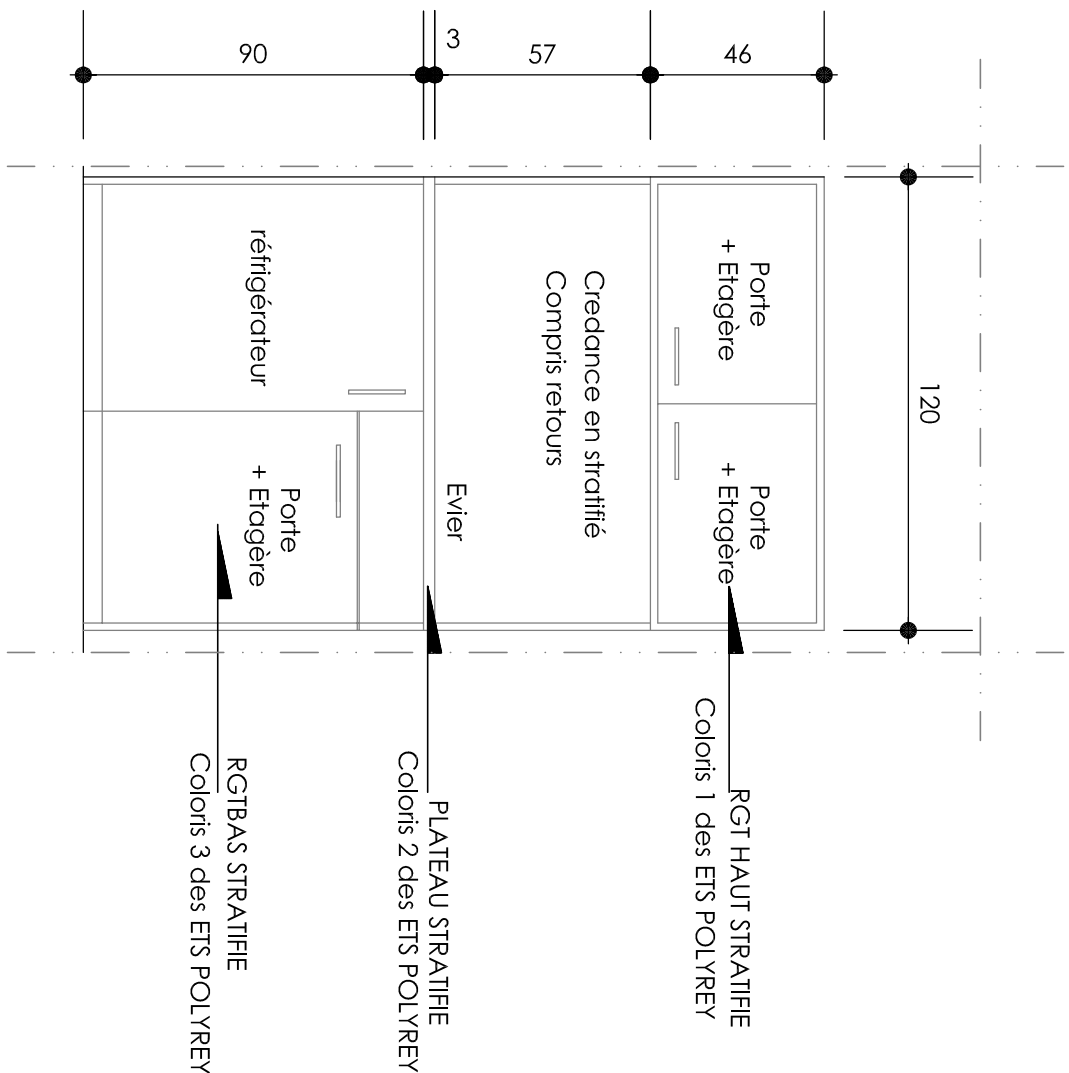
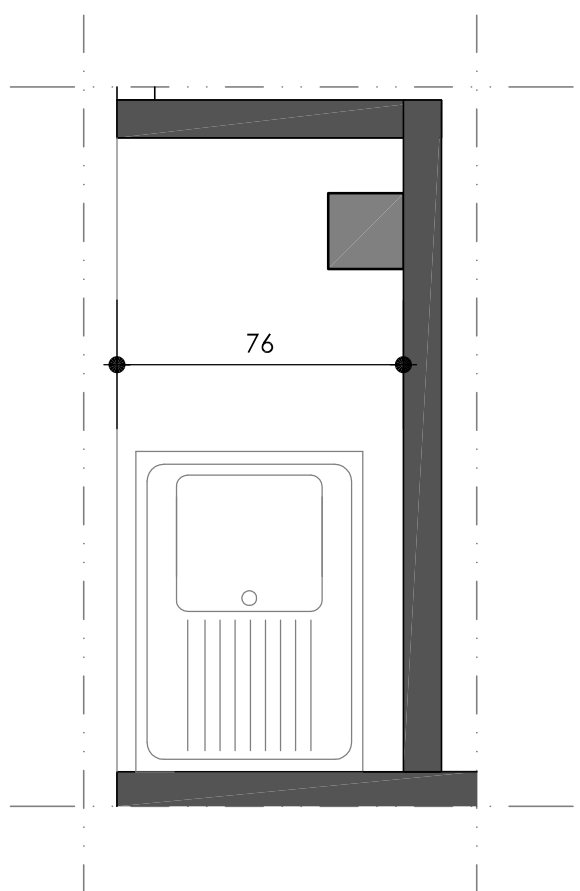
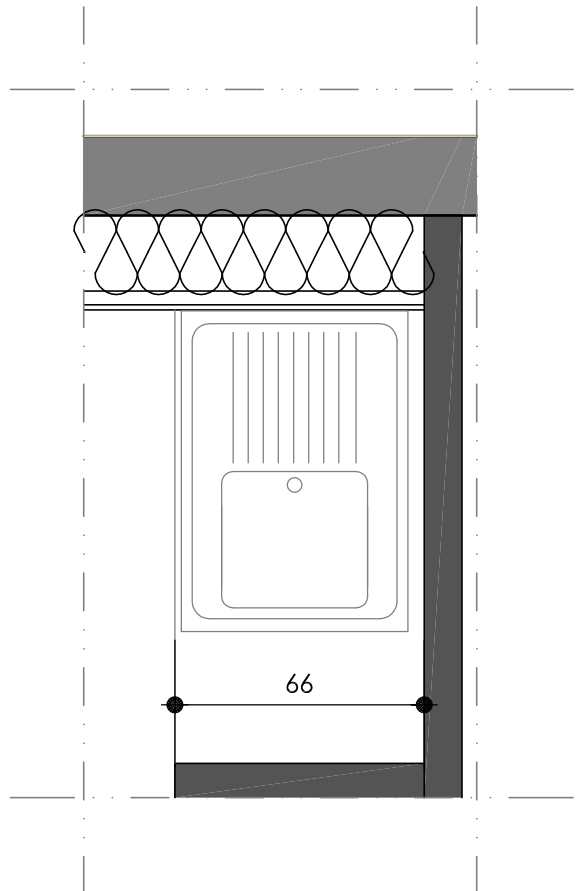
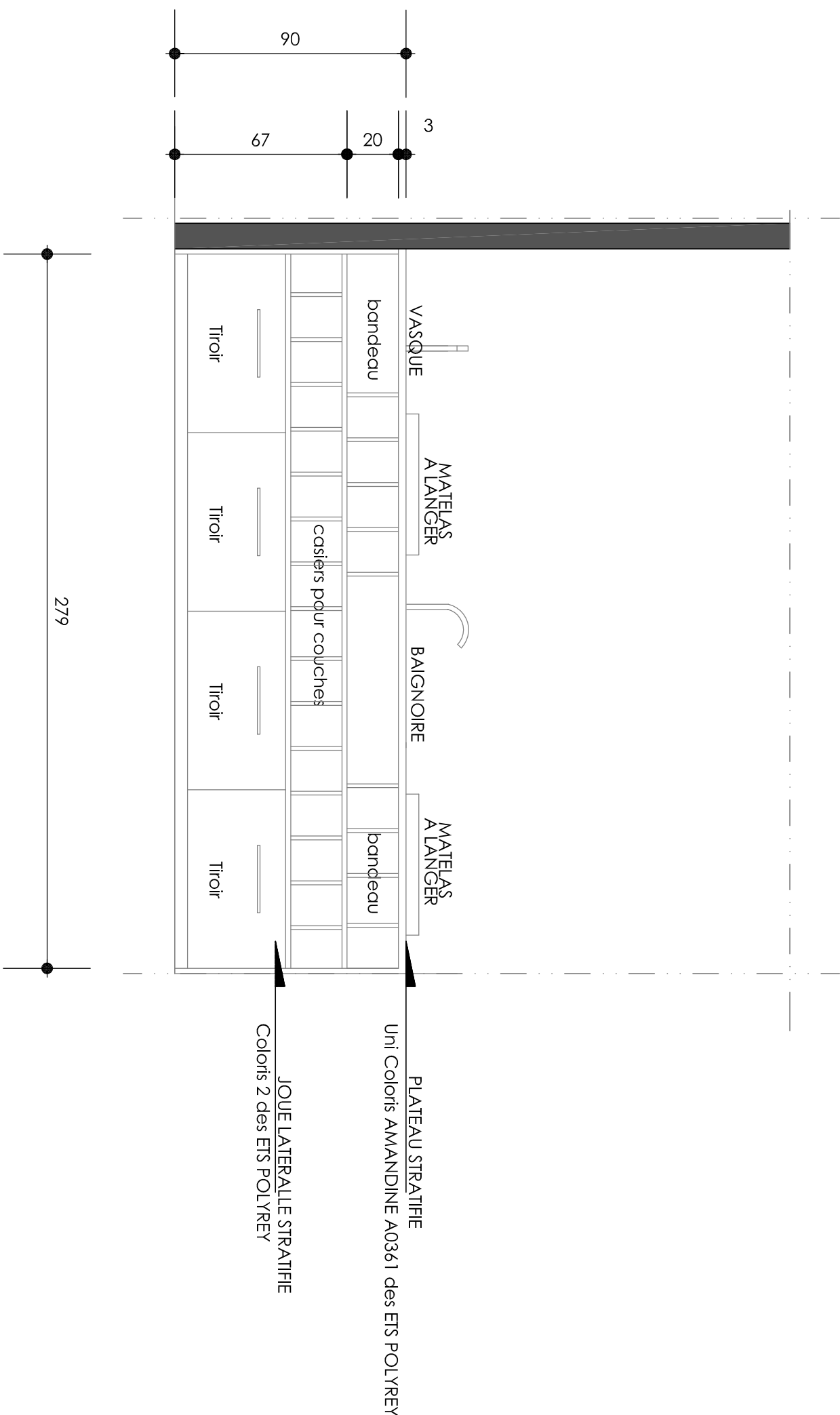
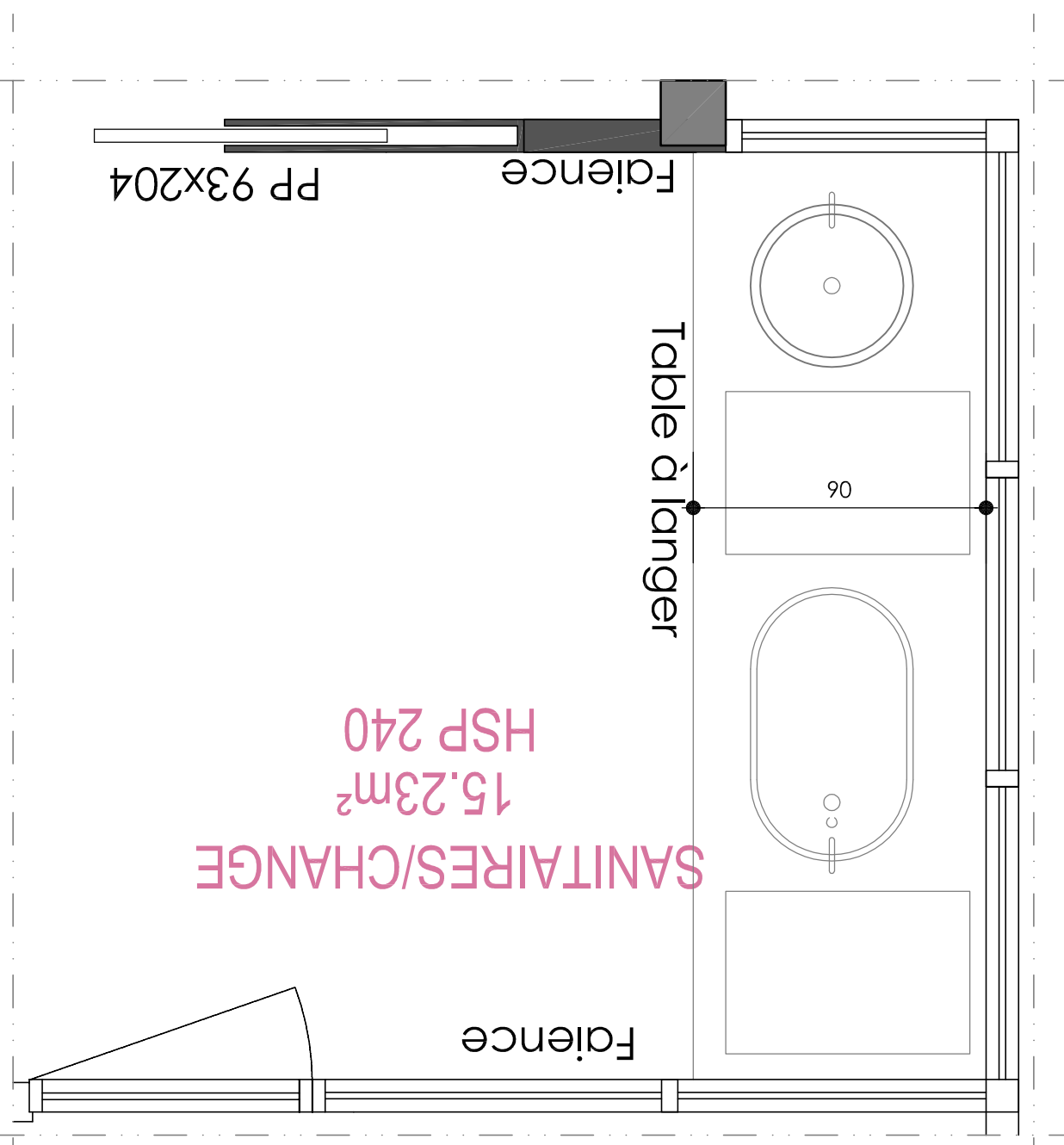

CHANGE RAM

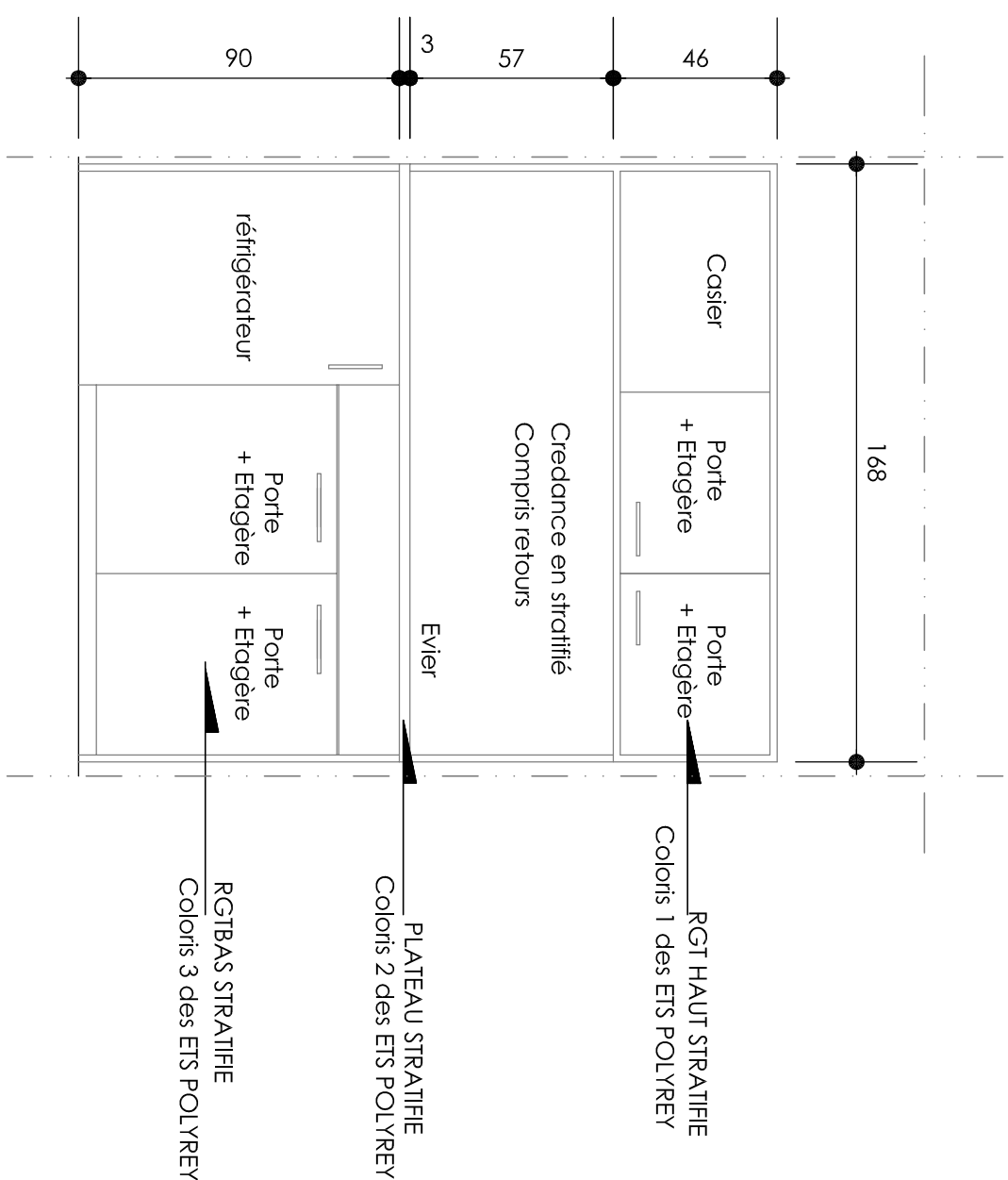

CHANGE CLSH

Construction d'un
Pole de la petite enfance

DCE

MAÎTRE D'OUVRAGE

MAÎTRE D'OUVRAGE

Commune de Noblat
24 de Soumagne
87400 SAINT LEONARD DE NOBLAT

PROJET
AGENCEMENT 1/20

ADRESSE DU PROJET
Avenue Dupuytren
87400 SAINT LEONARD DE NOBLAT

01/11 2015